

Heavy Duty Foldable Steel Wall Brackets

Models: LBBL-A

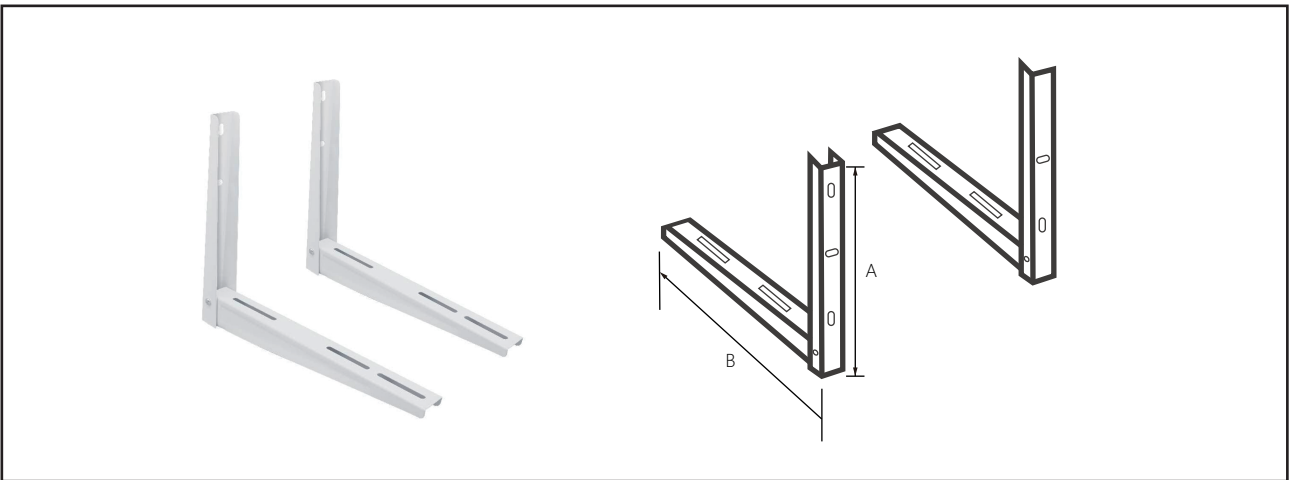

Model No.	Dimension (inch)	Thickness (inch)	N.W(lb)	Loading Capacity (lb)
LBBL-A1	14-2/5H x 17-7/10D	1/16	4.2	300
LBBL-A2	17-7/10H x 21-3/5D	5/64	5.7	400
LBBL-A3	19-7/10H x 21-3/5D	5/64	7	400

General Description

The LBBL-A wall brackets are designed to mount a mini-split air conditioner outdoor unit on a suitable wall or structure and keep the equipment off ground. The LBBL-A consists of two independently mounted wall brackets with a polyester powder coating finishing for corrosion protection. Four rubber vibration absorber are included for vibration and noise elimination.

Bracket with Cross Bar L Shape-A

ASSEMBLY INSTRUCTION

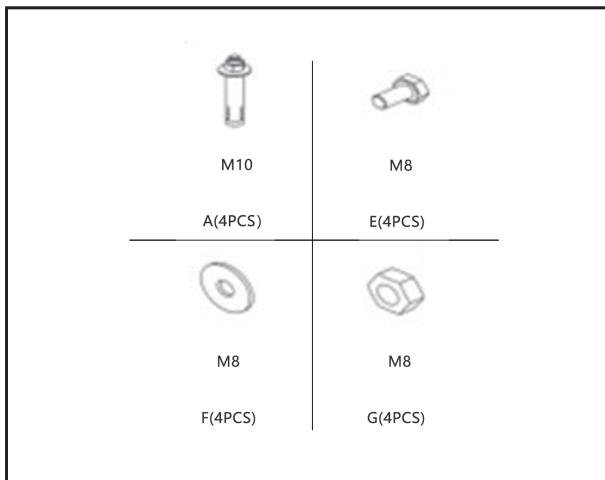

LBBL-A wall bracket is a foldable bracket which is pre-assembled for easy installation.

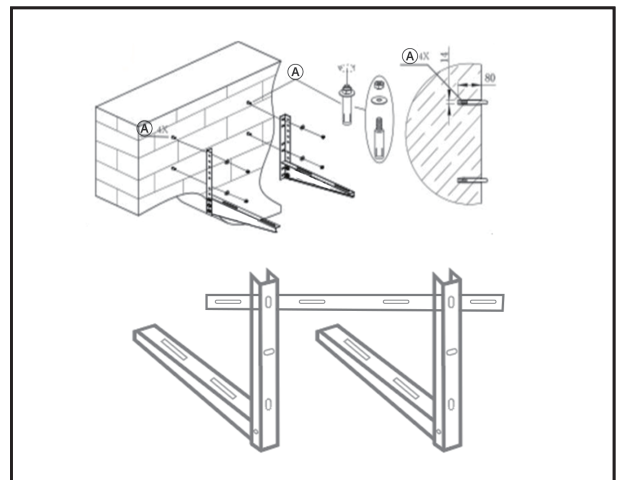

Make sure the chosen installation location meets with specified requirements and wall design and construction is suitable and strong enough to hold the brackets and the associated equipment loads. Anchors and related mounting hardware are provided.
