

Stainless Steel Expansion Bolt with Ring

Models: LBEBA-C



General Description

- Made of Stainless Steel 304.
- Resistant to corrosion and rust, strong and durable.
- Concrete anchor and masonry anchor , easy to be mounted.
- Different sizes available.

Stainless Steel Expansion Bolt with Ring

Models: LBEBA-C

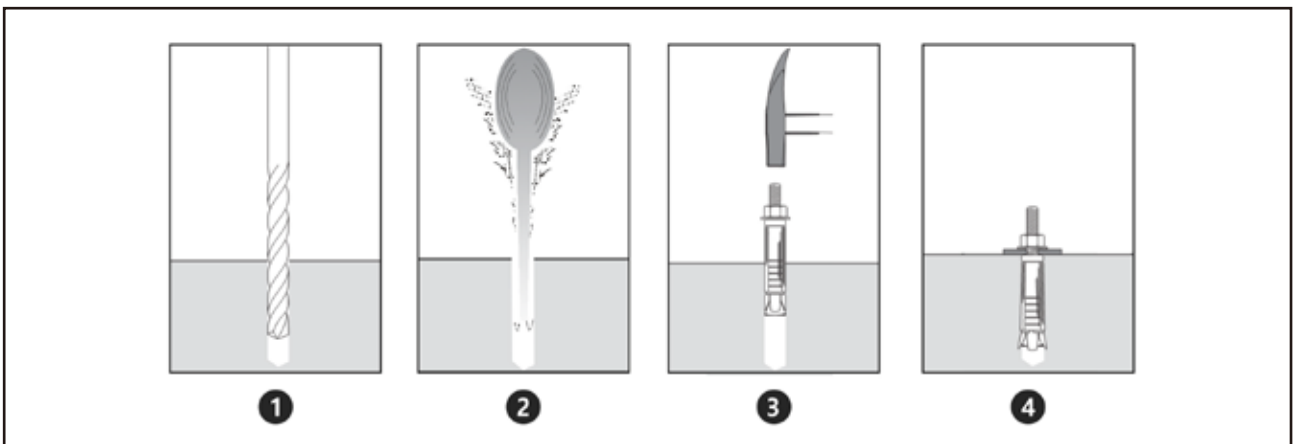

Installation Instruction

1. Drill a hole in where you want to place the bolt according to the expansion bolt size.
2. Clean up debris.
3. Insert the expansion bolt into the drill hole.
4. Tighten the nut using a wrench until the bolt expands.

Item	Size (mm)
LBEBA-C-6	M6
LBEBA-C-8	M8
LBEBA-C-10	M10
More sizes upon request	