

Stainless Steel Expansion Bolt

Models: LBEBA-B



General Description

- Made of Stainless Steel 304.
- Resistant to corrosion and rust, strong and durable.
- Concrete anchor and masonry anchor , easy to be mounted.
- Different sizes available.

Stainless Steel Expansion Bolt

Models: **LBEBA-B**

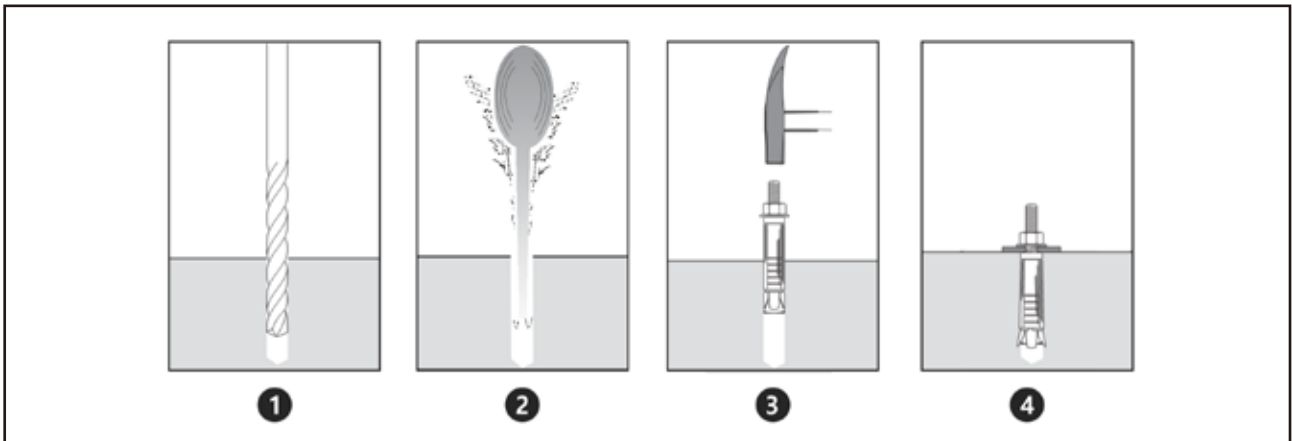

Installation Instruction

1. Drill a hole in where you want to place the bolt according to the expansion bolt size.
2. Clean up debris.
3. Insert the expansion bolt into the drill hole.
4. Tighten the nut using a wrench until the bolt expands.

Item	Size (mm)
LBEBA-B-66	M6 x 60
LBEBA-B-68	M6 x 80
LBEBA-B-610	M6 x 100
LBEBA-B-86	M8 x 60
LBEBA-B-87	M8 x 70
LBEBA-B-88	M8 x 80
LBEBA-B-810	M8 x 100
LBEBA-B-106	M10 x 60
LBEBA-B-107	M10 x 70
LBEBA-B-108	M10 x 80
LBEBA-B-1010	M10 x 100
More sizes upon request	